

# Instructions

3017 G17 TK00

© EPOCH

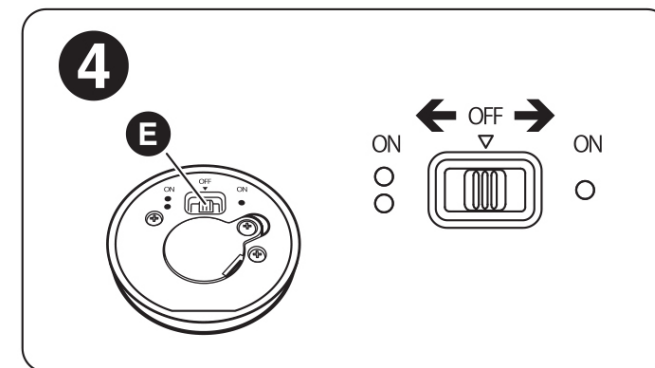
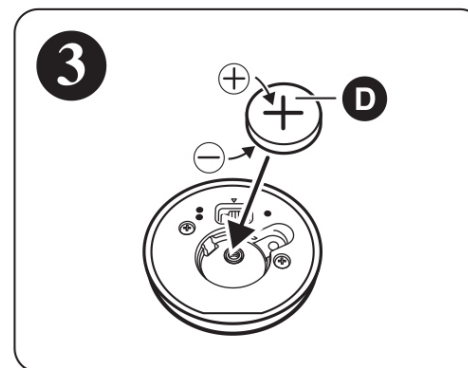
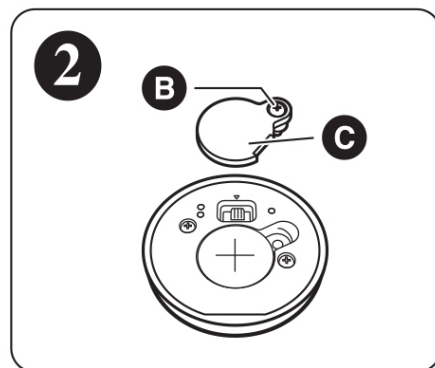
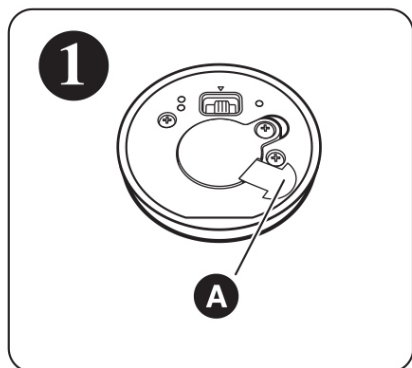

## Name

- A. Tab
- B. Screw
- C. Battery compartment lid
- D. Coin cell battery
- E. Switch

## How to replace the battery

2. Use a cross head screwdriver to remove the screw of the battery compartment lid.
3. Replace the coin cell (CR2032) as shown in the diagram. Make sure to insert it in the proper positive/negative (+/-) direction.

## Mode setting

4. ← Flickering light when slid to the left.  
→ Regular light when slid to the right.

## Note:

- Do not apply excessive force to the light switch. Doing so may damage or distort it.
- The included battery is for test purposes. When the light starts to get dim, replace the battery (coin cell [CR2032]).
- Battery life is approximately 15 hours of continuous lighting.
- The battery life could shorten depending on the battery type, capacity, and the way in which they're used.

## BATTERY CAUTIONS:

- Requires 1 x CR2032 3V battery, included.
- Do not mix old and new batteries.
- Do not mix alkaline, standard(carbon-zinc), or rechargeable batteries.
- Do not use rechargeable batteries. Non-rechargeable batteries are not be recharged.

## ⚠ WARNING:

This product contains a Button or Coin Cell Battery. A swallowed Button or Coin Cell Battery can cause internal chemical burns in as little as two hours and lead to death. Dispose of used batteries immediately. Keep new and used batteries away from children. If you think batteries might have been swallowed or placed inside any part of the body, seek immediate medical attention.

## Turning on

1. Grasp the tab and pull it out.